

## Features



**Fig 1: A4606-9202 LCD Annunciator with Red Trim**



**Fig 2: A4606-9205 LCD Annunciator with Platinum Trim**

**Remote Color Touchscreen LCD annunciators for use with Autocall model 4007ES fire alarm control panels**

### 4.3" (109 mm) diagonal color touchscreen display:

- Provides the display features of the 4007ES fire alarm control panel at a remote location
- Convenient and intuitive user interface provides detailed system status and individual point information
- LED status indicators include Alarm, Priority 2, Supervisory, Trouble, Alarm Silenced, and Status of AC Power at the control panel
- Supports dual language selection, including unicode character languages
- Keyswitch is used to enable default access level; additional user access levels are passcode protected; keyswitch and user access levels are configurable
- Tone-alert sounder provides local audible indication
- Three programmable control switches with status LEDs and provisions for custom labeling

### Additional features:

- Available with platinum or red trim
- Information is transmitted over a single unshielded twisted pair; separate wiring is required for 24 VDC power
- Mounts flush on RACO 944, 5-gang electrical box (supplied separately)
- Up to 6 Color Touchscreen LCD Annunciators per 4007ES fire alarm control panel

### Mounting box options (ordered separately):

- Surface mount boxes in red or platinum
- Semi-flush mount boxes in red or platinum, may be used for legacy annunciator retrofit applications

## Description

### Local Annunciation and Control

A4606-9202 and A4606-9205 Series LCD Annunciators allows 4007ES fire alarm control panels to provide information and control switches at convenient locations away from the control panel. The color touchscreen LCD with backlighting displays information in clear and descriptive language. (English is standard, other languages can be programmed.) Typical content includes: point status (alarm, trouble, etc.), alarm type (smoke detector, manual station, etc.), number of system alarms, supervisory conditions, troubles, and custom location labels up to 40 characters long.

### Communications

Data communications require a single unshielded twisted pair that supports other annunciators on the same communications channel.

### Indications

Alarm, Priority 2, Supervisory, Trouble, and Alarm Silenced conditions are indicated by dedicated LEDs and a tone-alert audible indication. Each condition will cause the display to present a dedicated acknowledge push-button switch that silences the tone-alert but leaves the LED on until all conditions in that category are restored to normal.

### Custom Background

The 4007ES control panel supports a custom background image that is also displayed on each of the color touchscreen annunciators when status is normal. File types supported are JPG, BMP, GIF, and PNG. Recommended image type is JPG, recommended image size is 480 x 240, and the file size limit is 100 kb.

## Operation

### Keyswitch Access

Touchscreen display access can be controlled by a keyswitch with a key that is removable only in the disabled position. Access is configurable per annunciator.

### Enabled Operations

When the keyswitch is on, system status indications will be displayed as they occur with individual point detail as programmed at the control panel, and soft keys will be displayed to allow user actions.

### Screen Backlight

When the display has not been touched, and no new system status has occurred for 60 seconds, the backlight dims to 20% of normal brightness. If there is no activity in the system (System is Normal), the standby screen displays current time and date to verify proper operation. If an event occurs, or with the keyswitch activated, and the screen is touched, the backlight returns to full intensity

### Lamp Test

The display menu provides a lamp test feature that when selected, activates the 9 panel LEDs for 5 seconds. Dual-color LEDs will blink alternately.

## Product Selection

Table 1: Annunciator Product Selection

SKU	Color	Description	Dimensions
A4606-9202	Red	Remote Color Touchscreen LCD Annunciator; for flush mounting in a 5-gang RACO 944 box, or equal, supplied separately	Annunciator: 13" W x 5.21" H x 2" D (330 mm x 132 mm x 51 mm)
A4606-9205	Platinum		RACO 944 Box (reference): 12 ¼" W x 4 ½" H x 2 ½" D (311 mm x 114 mm x 64 mm)
A2975-9461	Red	Surface mount metal box for above annunciators	12 ¼" W x 4 ½" H x 2 ½" D (311 mm x 114 mm x 64 mm)
A2975-9462	Platinum		
A2975-9463	Red	Semi-flush mount metal box adapter for above annunciators; use for mounting on existing 2-gang, 4-gang, 6-gang, or 4" (102 mm) square flush mounted boxes	12 ¼" W x 4 ½" H x 1 ¾" D (311 mm x 114 mm x 44 mm)
A2975-9464	Platinum		

**Note:** SKUs ending with BA are assembled in the USA.

Table 2: Suppression Products

SKU	Description	Additional Reference
A2081-9044	Overvoltage Protector, rated for up to 200 mA; use for RUI communications	Data Sheet AC2081-0016
A2081-9028	Isolated Loop Circuit Protector (ILCP), rated for 5 A maximum; use for 24 VDC power wiring when above 200 mA	Data Sheet AC2081-0008

**Note:** Suppression is required where annunciator communications and power wiring exits and enters a building.

## Operator Information

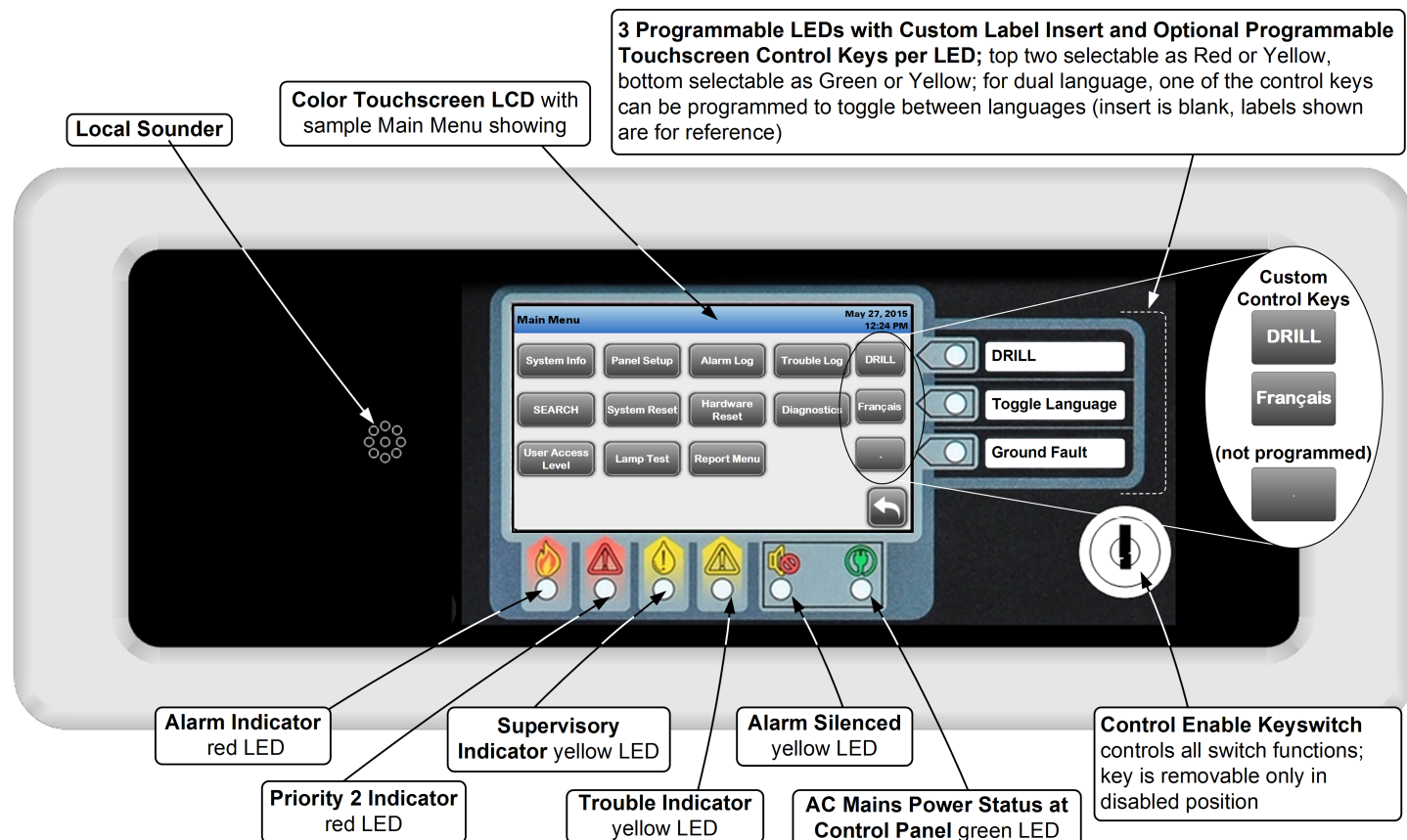

## Operator Screen Reference

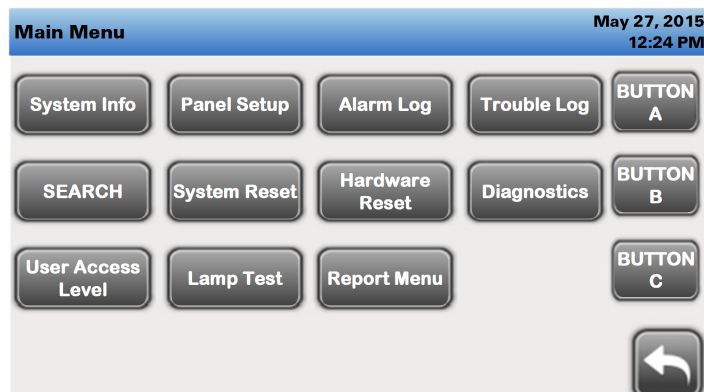

Fig 3: Main Menu Screen provides easy navigation to the function required. Buttons A, B, and C have programmable functions.



Fig 4: System Alarm Screen identifies active alarms with custom labels displayed, arrows allow navigation through the list

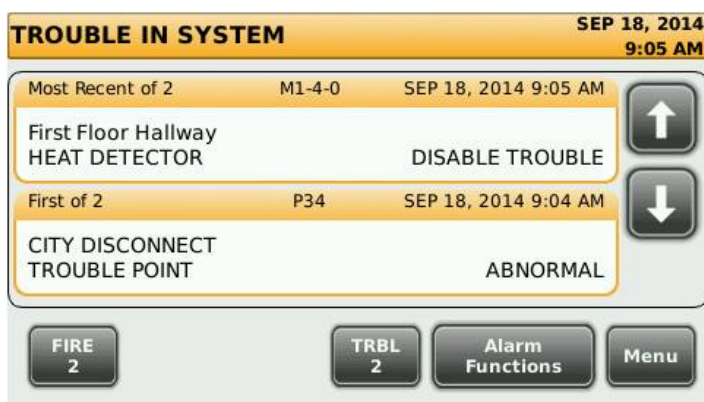

Fig 5: System Trouble Screen identifies active troubles with custom labels displayed, arrows allow navigation through the list

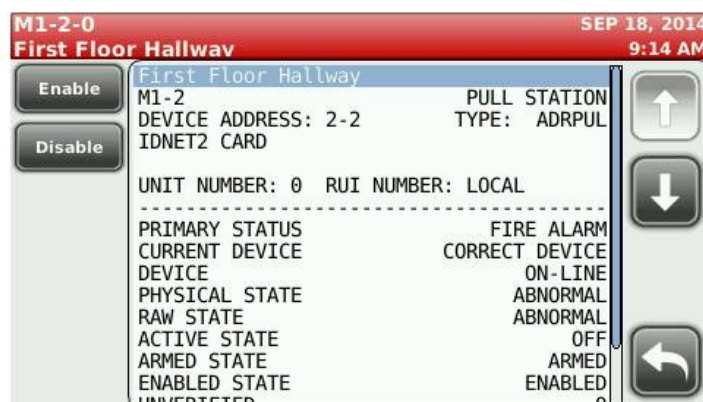

Fig 6: Point Information Screen allows review of point details, arrows allow navigation through the information.

## A4606 Series Color Touchscreen LCD Annunciators for 4007ES Fire Alarm Control Panels

### Specifications

**Table 3: General Operating Specifications**

Specification		Rating	
Voltage		18 to 32 VDC, system supplied	
Current Details	Condition	Current	Details
	Alarm	124 mA	Backlight at full intensity and tone-alert sounding
	Display Active	70 mA	Backlight at full intensity, occurs when activity is in process
	Standby	45 mA	Backlight dimmed to 20% of full intensity, occurs after 1 minute of no system activity
Operating Temperature Range		32° to 120° F (0° to 49° C)	
Operating Humidity Range		Up to 93% RH, non-condensing at 100° F (38° C)	

**Table 4: Communications**

Specification		Description
For 4007ES Panels	Type	RUI (Remote Unit Interface) external annunciator communications line SLC (signaling line circuit)
	Capacity	Up to 6 Color Touchscreen LCD Annunciators

**Table 5: Wiring Requirements**

Specification		Description
RUI Data	Standard Wiring Type	Unshielded twisted pair (UTP), 18 AWG (0.82 mm <sup>2</sup> ) for most applications, see below
	Wiring Characteristics	0.58 µF (580 nF) maximum capacitance between conductors; 35 Ω maximum total line resistance
	Wiring Applications Requiring Shielded, Twisted Pair (STP)	Wiring that leaves the building. RUI wiring also requires A2081-9044 Overvoltage Protectors on each end. Wiring run in 500 ft (152 m) or more of conduit. Wiring closely bundled with standard IDNet communications or TrueAlert addressable communications (not required when run with IDNet+ communications).
	Class B "T-Tap" wiring distance	Up to 10,000 ft (3048 m) total wiring; up to 2500 ft (762 m) to farthest device
	Class X wiring distance	Up to 2500 ft (762 m)
Power Wiring		Terminals for 18 to 12 AWG (0.82 mm <sup>2</sup> to 3.31 mm <sup>2</sup> ) wires for 24 VDC system power
Earth Wiring		A dedicated earth ground connection to the electrical box is required for proper ESD and EMI protection; wire in accordance with NFPA 70 (National Electrical Code) Article 250

**Table 6: Mounting Information**

Item	Description
Boxes for Flush Mounting (supplied separately)	5-gang masonry box, RACO # 944, 2 1/2" (64 mm) deep or equal

Table 7: Additional Reference

Reference	Description
Installation Instructions	579-1172AC
4007ES Data Sheets	AC4007-0001, 4007ES Hybrid
	AC4007-0002

## Mounting Information

**Surface Mounting:** Use Surface Mount Box 2-1/2" deep (64 mm) (ordered separately)

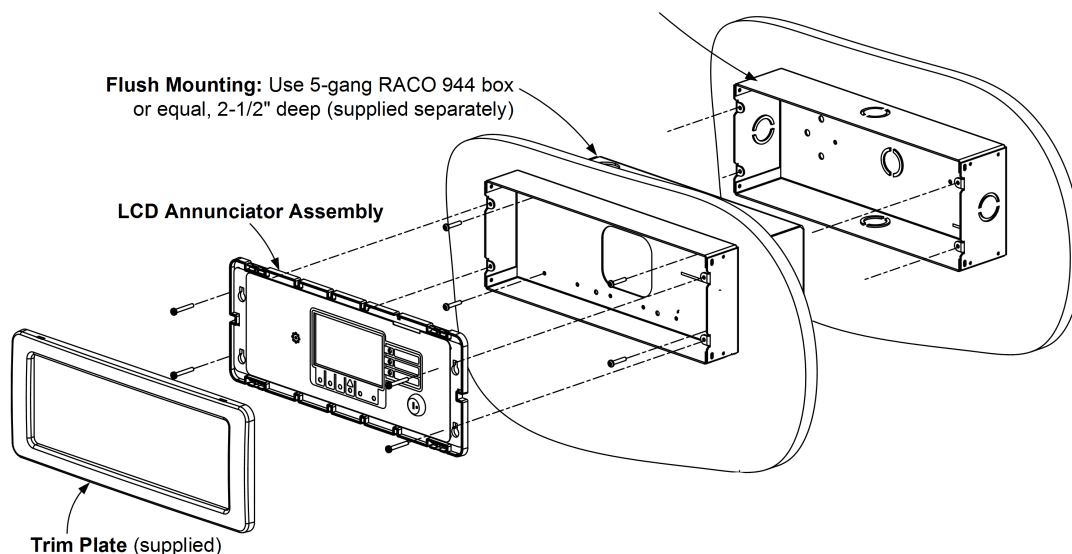
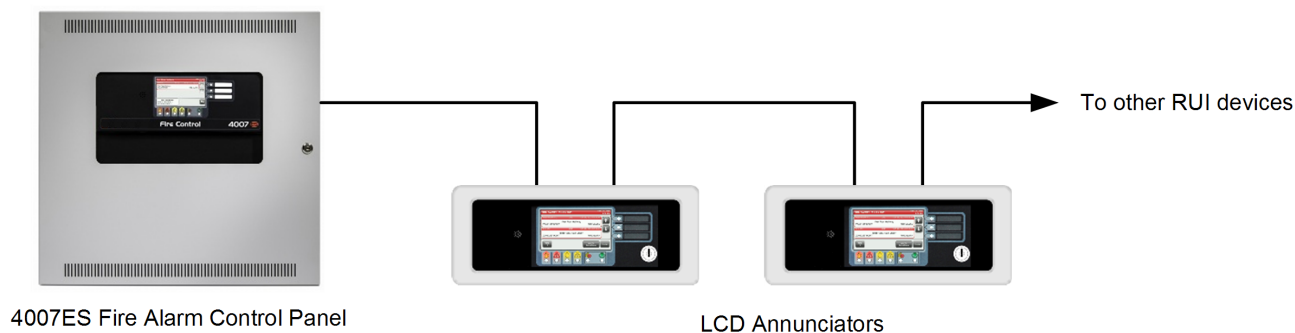

Fig 7: LCD Annunciator Mounting Information

### Note:

- For surface mounting, use Autocall Surface Mount Box Model A2975-9461 (red) or A2975-9462 (platinum), 2-1/2" deep (64 mm) (ordered separately).
- For semi-flush mounting, use Autocall Semi-Flush Box Adapter Model A2975-9463 (red) or A2975-9464 (platinum), 1-3/4" deep (44 mm) (ordered separately); use for mounting on existing 2-gang, 4-gang, 6-gang, or 4" square flush mounted electrical boxes (supplied separately).

## Wiring Reference



[Wiring Reference](#) on page 5 shows A4606-9202 LCD Annunciators.

### Note:

#### Interconnection Wiring

- Communication requires 18 to 12 AWG unshielded twisted pair.
- Power requires two, 18 to 12 AWG wires for 24 VDC system power, plus earth ground to each electrical box.
- Refer to Install Instructions 579-1172AC for additional wiring specifications.

