

Features

Remote LED/Switch annunciator for the Autocall 4006 fire alarm control panel with:

- 16 LEDs with functions programmable at the host panel to indicate specific system conditions and locations (Alarm, Supervisory, Trouble, etc.)
- Dedicated LEDs that indicate Alarm Silence, Trouble, Communication Loss, and Power-on
- Local tone-alert audible indicator

Keyswitch access control switches provide:

- Event Acknowledge, Alarm Silence, System Reset, and local Lamp Test

Programmable LED options:

- 10 Red LEDs to indicate Alarm conditions by programmable area
- 6 Yellow LEDs to indicate Trouble conditions
- Custom label inserts describe LED functions

Wiring requirements:

- Twisted pair for communications
- 24 VDC system power via separate wiring

Mounting options:

- Flush mount uses standard 5-gang electrical boxes

UL Listed to Standard 864, 9th Edition

Description

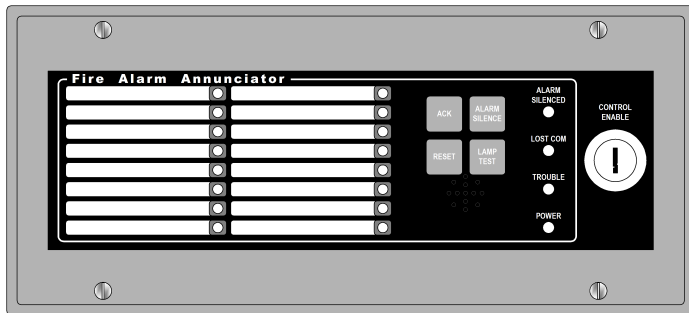

Fig 1: A4610-9111 LED/Switch Annunciator

Remote LED Annunciation.

Autocall A4610-9111 LED/Switch Annunciators provide remote fire alarm system status and control with 16 programmable LEDs to provide location specific information. Keyswitch controlled access allows pushbutton switches to activate Acknowledge, Alarm Silence, system Reset, or local Lamp (LED) Test. Label inserts allow custom LED specifics to be identified.

Dedicated LEDs and Remote Switch Control.

LEDs indicate Alarm Silenced, Communications Loss with panel, Trouble, and local Power-on, along with a local tone-alert audible indication. Activating the Acknowledge push-button switch silences the system tone-alerts, but leaves the LEDs on until all conditions in that category are restored to normal. LED operation (continuous or pulsing) is programmed at the control panel.

Multiple System Annunciators.

Annunciator communications for these panels can include up to four devices, including the LED/Switch Annunciator; an LCD Remote Annunciator, and the optional host panel door-mounted LED Annunciator.

Additional Information.

Refer to LED/Switch Annunciator Installation Instructions 579-710AC and to the host panel instructions.

Specifications

Table 1: General Specifications

Specification	Rating
Voltage	18 to 33 VDC, system supplied
Standby Current	40 mA
Alarm Current	70 mA maximum (all LEDs and tone-alert on)
Operating Temperature Range	32° to 120° F (0° to 49° C)
Operating Humidity Range	Up to 93% RH, non-condensing at 100° F (38° C)

Table 2: Annunciator Communications

Specification		Rating	
Quantity Supported		Up to four annunciator modules per panel	
Wiring Type		Twisted pair, or twisted, shielded pair; 18 AWG (0.82 mm2)	
Distance	Bus-style wiring	Up to 4000 ft (1219 m); 0.58 μF (580 nF) maximum capacitance; 35 Ω maximum resistance	
	"T-Tap" wiring	Up to 10,000 ft (3048 m) total wiring; up to 2500 ft (762 m) to farthest device	
Line Matching Resistor	Bus-style wiring	Connect one at panel and one at end of line	100 Ω, 1/2 W; PID A4081-9011;
	"T-Tap" wiring	Connect one at panel and one at farthest device	(part number 733-974)
Suppression for wiring external to building		Use A2081-9044 Overvoltage Protectors where wiring leaves and enters a building (refer to data sheet AC2081-0016)	
Power Wiring		24 VDC system power and Earth ground for electrical box (ground per local code)	
Wiring Connections		Provisions for in/out wiring; 18 to 12 AWG (0.82 mm2 to 3.31 mm2)	

Table 3: Mounting Information

Specification	Rating
Trim Dimensions	10" W x 4-1/2" H (254 mm x 114 mm)
Trim Material	Painted steel, red
Boxes for Flush Mounting (supplied by others)	Standard 5-gang boxes with conduit entrance restrictions, refer to installation information in Mounting Information on page 3.

Product Selection

Table 4: Product Selection

SKU	Description
A4610-9111	LED/Switch Annunciator, red trim
A4081-9011	Line matching resistor; 100 Ω , 1/2 W; (part number 733-974); see specifications on page 3 for location and quantity
A2081-9044	Overvoltage protector; required where annunciator communications and power wiring exits and enters a building; refer to data sheet <i>AC2081-0016</i> for details

Annunciator Detail View

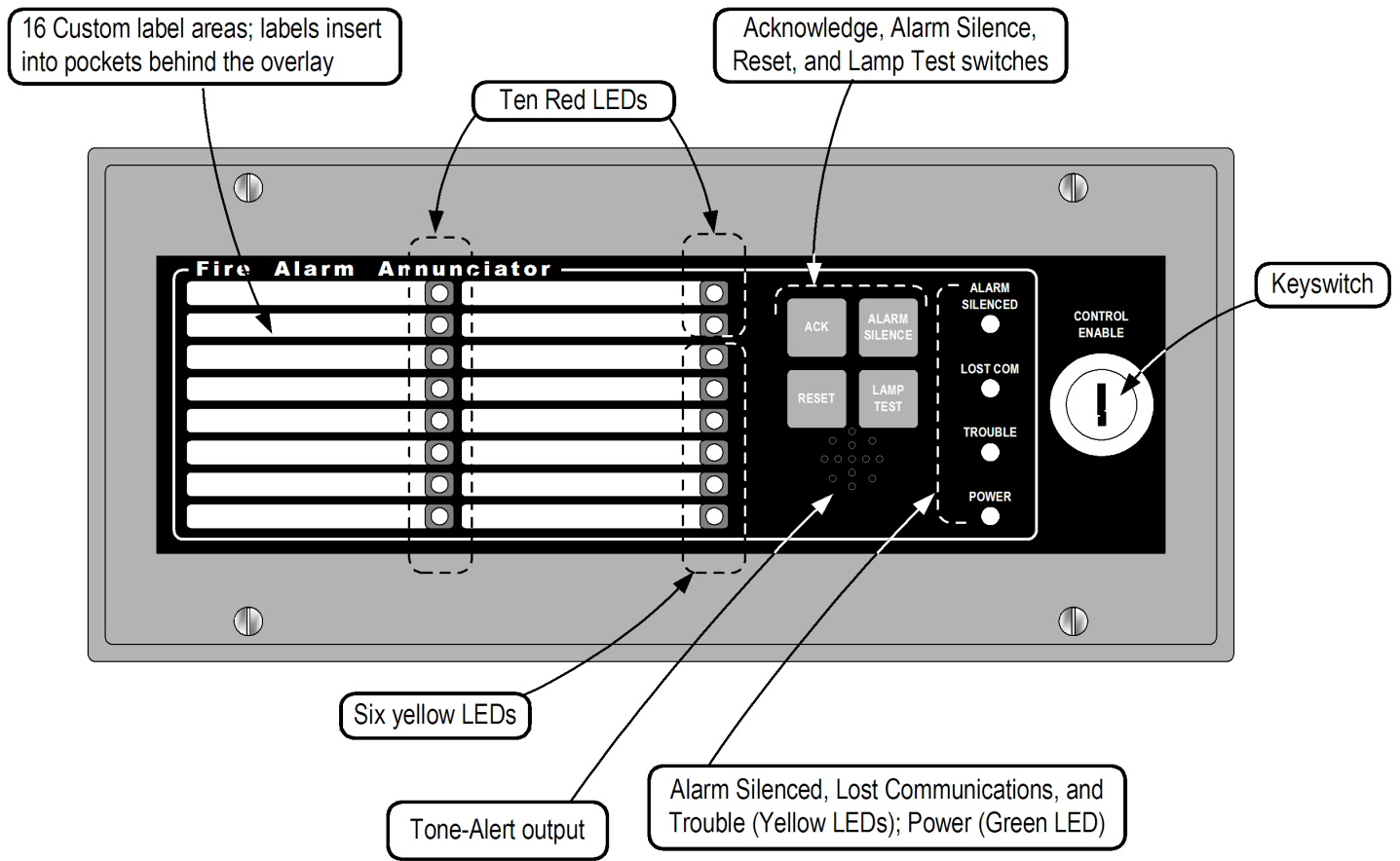

Mounting Information

Compatible Mounting Boxes

1. Matching surface mount box (shown), ordered separately.
2. For flush-mount, use 5 gang boxes per below.

Note: To avoid interference with the annunciator, use only conduit knockouts that are 2-1/2" (64 mm) from front of box or as noted below.

3. For masonry box, use RACO 699 (or equal), 3-1/2" (89 mm) deep.
4. For plasterboard walls, use RACO 590, 3-1/2" deep; or RACO 600 (or equal); use side knockouts or cable clamps top or bottom).

